



ORO BRIDGE STRUCTURES

CASE STUDY

Four Bridges - Ambogo River and Eroro River in the Oro province of Papua New Guinea were destroyed by Cyclone Guba in 2007. Construction of the new bridges were scheduled in January 2014.

The lengths of the four bridges were as follows:

- Eroro Bridge - 66 metres
- Ambogo River - 100 metres
- Girua River - 150 metres
- Kumusi River - 285 metres

ESC Steel Structures was awarded by Main Contractor Canstruct in Australia to fabricate all steel components for the four bridges. ESC's scope of work was to fabricate over 1,500 tons of steel bridge girders and other components such as elastomeric bearing sets, guard rails, scuppers, edge forms, bracing, splicing plates, channels, lifting lugs and more. The girders were between 1.25 and 2.06 metres high and the lengths were up to 15.0 metres long.

The bridge designs consisted of four steel continuous girders with cast in situ concrete decks. It required a design life and capacity for a 2,000 year flood.

The 4 bridges were successfully opened to public in July 2016.

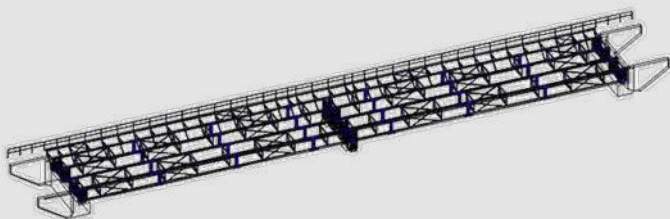

Get in Touch: T +852 8198 0239
E info@escsteelstructures.com
W www.escsteelstructures.com

ESC App available now on
all smartphones & tablets
Search for "ESC Group"

